

Kiki&Co photo frame

User manual



KIKI&CO

V3.0 May 2021, 2105LiBl10.LiBW10

Enjoy this truly special gift!
From now on, you can invite your loved ones
to share their most beautiful, funny, crazy,
precious, awkward and ordinary photos with
you on the Kiki&Co digital photo frame.

Thank you for your purchase!





This user manual is intended to explain all functions and capabilities of the photo frame. The software is regularly updated so features may change and improve over time. Read the manual carefully and keep it for future reference. The photo frame itself also contains explanations of all functions in multiple languages.

Warning

To reduce the risk of fire or electric shock, do not expose this appliance to rain or moisture.

- Read the manual carefully and follow all requirements for safe use.
- Do not use the photo frame near water. Do not place next to a container with liquid in it.
- Do not install near heat sources such as radiators, heat registers, stoves, or other appliances that produce heat.
- Unplug the photo frame during lightning storms or when unused for long periods of time.
- Cleaning: unplug the appliance, use a wet cloth to clean. Do not use liquid detergent or aerosol sprays.
- Only use accessories specified by the manufacturer.
- If the photo frame is damaged in any way, such as a damaged plug or spilled liquid, do not try to repair it yourself due to the danger of electric shock.

Table of contents

Get started	5
Sending pictures & videos	6
Navigating your frame	7
 <i>Add friends</i>	7
 <i>Settings</i>	7
<i>On/off button</i>	7
 <i>Hide photo</i>	7
 <i>Gallery</i>	7
<i>Displays all photos on the photo frame in smaller form. Easy to search for a photo.</i>	7
 <i>Fit to frame/ Fill frame</i>	7
<i>Adjust photo</i>	7
Advanced settings on the frame	8
<i>My frame</i>	8
<i>Manage photos</i>	8
<i>My friends</i>	8
<i>Display</i>	9
<i>Slideshow</i>	9
<i>Wi-Fi</i>	11
<i>Notifications</i>	11
<i>Back-up and restore</i>	11
<i>Help</i>	11
<i>About</i>	11
Specifications	12

Get started

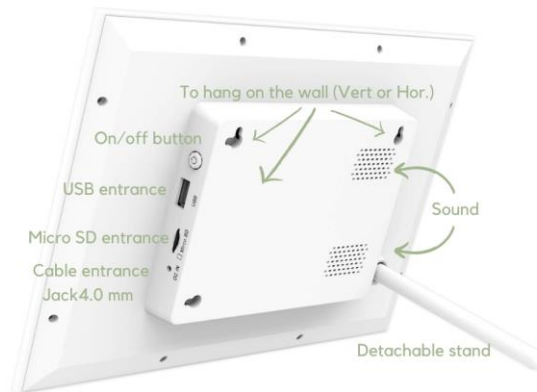

In the box

- Photo frame
- Stand / leg to let the frame stand
- AC adapter (with EU plug & in some cases also UK plug)

Connections

USB: A micro-USB stick can also be used to import photos and to make a backup.

Micro SD: Micro SD can be used to import and backup photos. Format micro SD in MSFAT32 for reading. Note: MSfat can only be used for cards up to 32 GB.

DC output 3.5mm jack: for power supply with supplied AC adapter. Works with 220V and 110V. Plug is (Northern) European. An English plug is also included when sold in Great Britain. The photo frame does not work on rechargeable batteries or batteries.

Stand / Leg

To place the photo frame in a landscape or portrait position.

Place the stand in the hole and push down to secure. The photo frame can also be hung on the wall.

First time turn on

Plug in the power cord and press the on button for 2-3 seconds.

When starting up for the first time, the photo frame must be set. The setup menu starts automatically. The photo frame has a touchscreen. These are the first steps:

- Select language. This is the language used in Frameo.
- Connecting to Wi-Fi. Connect to Wi-Fi to receive photo's too
- Update to the latest version. If a new version of the Frameo software is available, you will be asked if an update can be done. Advice is to always do this, in order to be able to use the latest functionality.
- Enter name and location for the photo frame. Both are visible to people who share photos with you. Set the time zone if it is not already correct.

Sending pictures & videos

To send photos and videos to the photo frame, the sender must install the Frameo app on his or her phone. The sender's photo frame and phone must become 'Friends' once, after which you can send unlimited photos.

Follow the steps below:

1. **Install Frameo** for Android or iOS in the [Google play store](#) or in the [App store](#).
Tip: If you have registered a phone outside of Europe, you may not be able to find the app directly in the app store. You can find it via a Google search and click on it to download the app from the app store.



2. Click the icon '**Add Friend**' (a person with a plus sign) on the photo frame. A window will appear with the connection code that is valid for 12 hours. Share this code with the person who wants to share photos.
3. Now click on 'Add friend' in the app. This logo is in the top left corner of the app. **Enter the photo frame code** that was generated on the frame into the app.

You are now connected to the photo frame and you can start sending photos.

It works like this:

1. Go to the Frameo app and **select a photo or video from an album**. You can also select multiple photos at the same time by clicking on the sign with squares one after the other, at the top left of the large photo. You can select an album from which you want to send photos. Then click 'Next' top right.
Note: A maximum of 15 seconds of a video clip will be shown on the list. You can select which 15 seconds if desired.
Tip: If you want to send older photos and don't want to scroll to them in the Frameo app, do the following. Go to photos (IOS), select the image, export (square with up arrow, bottom left) to Frameo and send. If the Frameo app is not displayed when you export, you can add it by clicking 'More'.
2. **Select the photo frames** you want to share the picture(s) with. Click on 'Next' again
3. Optionally, **enter a caption** that will appear with the photo. You can also use emojis. Click on 'Next' again.
4. Select the **most important part of the photo**. If the measurements of the photo do not exactly match the screen size, this area will always be displayed anyway.
5. Click on '**Send Image**'. Within seconds, the photo will appear on the photo frame screen.
Please note: if the list is not online when you send the photo, the photo will not arrive immediately at the recipient. The Frameo app will keep trying until the photo can be sent.

Navigating your frame

You can operate the photo frame with the touchscreen. By default, the photos are displayed one by one as a slide show. Swipe left or right to scroll through the photos. Tap the screen once to open the quick menu. In the quick menu there is a link to the extensive Settings menu. If there are new photos or a software update, this can be seen by a pop-up at the top left of the screen.

In the shortcut menu you will find the following options:

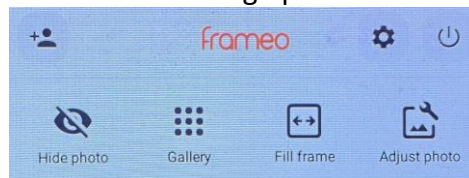

+ Add friends

This generates a code that you can share with friends or family so that they can connect to the frame and send photos to your frame.

⚙ Settings

This opens the advanced settings menu.

🔌 On/off button

Clicking on this will give you three options. Turn it off completely, so you will no longer be able to receive photos. Restart, the photo frame will turn off and then turn on again immediately. Or Sleeping, that means the screen is off, but pictures can still come in.

🙋 Hide photo

Tap this icon, the photo will be hidden and no longer shown. If you still want to show the photo again, you can go to Settings-> Manage photos-> Show / hide photos

📖 Gallery

Displays all photos on the photo frame in smaller form. Easy to search for a photo.

🖼 Fit to frame/ Fill frame

With this you switch between filling the entire frame with the photo (and therefore possibly cutting a piece) or fitting the entire photo into the frame (and thus possibly a piece empty next to the photo).

🔧 Adjust photo

This option allows you to move the photo around the screen so that you can show the part that is most important. Of course, only applicable if not the entire photo is shown.

Advanced settings on the frame

You can reach the settings via the quick menu by clicking on the gear wheel.

My frame

Frame name - name of the photo frame, will be shown to the sender.

Frame location - location of the photo frame, will be shown to the sender.

Set language - here you can change the language of your choice.

Set time zone - time zone is set to Dutch time by default. Can you adjust here.

Use 12/24 hour format - switch between 12 or 24 hour format

Manage photos

Above you can see how many photos and videos are on the photo list and how much space they take up. The photos are optimized by the app and saved in WEBP format, so that they can be seen perfectly sharp, but do not use more space than necessary. That is why more than 10,000 photos fit on the photo frame.

Show / hide photos - Here you can hide or bring back photos. You can do this one by one by clicking on the desired photo. An eye with a line through it appears when the photo is hidden. Or that can be done for all photos at the same time by clicking on the two squares at the top right.

Delete photos - Here you can delete photos. Select the desired photos. A trash can can be seen on the photos you select. Then click on the trash can at the top right to permanently delete the photos. They are then no longer on the photo frame and can no longer be retrieved.

Import photos - Import photos from an external micro SD card or USB stick. Select the photos you want to import to the frame. Tap the import to start the import process.

Note: Micro SD card must be formatted in MSfat in order to read. Formatting in MSfat is only possible for micro SD cards that are 32 GB or smaller.

Note: It is not possible to add a caption or define the main part of the photo when using the import function.

Export pictures - Export photos to micro SD card, so you get the pictures can be used elsewhere. In the menu-item Back-up you can also ensure a periodic back-up of the photo's is made on the SD card.

My friends

This list contains all the people who are allowed to send photos to your frame.

To remove a person from this list and thereby remove their permission to send photos, tap the Settings button next to their name. You can then choose to remove that person

To allow a new person to send your photos, tap the 'Add Friend' button in the top right and share the code with this person. The code is valid for 12 hours. It is only necessary once to 'become a friend' with the photo frame. Then you can send unlimited photos.

You can give 'a friend of the photo frame' permission to share the code of the photo frame itself. This friend can then add new friends without permission. This can be useful if you don't want to burden the owner of the list with this. Click on settings and check 'Allow friend to share code to this frame'.

Display

Brightness - Adjust the brightness of the screen with the slider bar

Sleep mode - The photo frame has a sleep mode that turns off the screen to avoid using unnecessary power while you sleep or are usually away. The default setting is to turn the screen off at 11:00 PM and turn the screen back on at 7:00 AM. You can adjust the times in this menu. The photo frame is not turned off in sleep mode, so receiving photos is still possible during sleep mode.

Slideshow

Timer – Set how long each photo is displayed. 10 seconds to 30 minutes.

Show caption – Set whether to show the captions that friends have sent

Fill Frame / Fit to Frame – The Fill Frame option is the factory default setting. The photo is scaled to fill the entire screen. The photo will be centered on what is selected as the main part. See the first photo below. Fit to Frame makes sure the whole photo is on the screen. See the second photo below.

Fill frame



Fit to frame

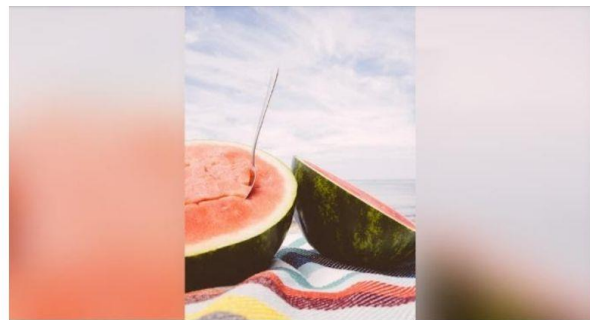

Photo display order - Set by date or in random order (shuffle)

And for video:

If a video is on the screen, you can play or pause it manually and adjust the sound using the touchscreen. You can adjust the default settings in the menu below

Auto play - when the video comes along, it plays automatically. Uncheck if you only want the videos to start manually.

Video playback - choose from three options:

- videos in a loop: show the video until the set time per photo (the timer) has elapsed
- play once: show the video 1 x and then show the start image until the timer time has expired,
- play once and continue: show the video 1x and go to the next photo.

Video volume - adjust the volume at which the sound of the videos is played with the slider.

Wi-Fi

Choose the Wi-Fi your photo frame should connect to and enter the password.

It is also possible to connect and then log in with name and password, as is regularly used in hotels or nursing homes. As soon as there is a connection to the WiFi network, a button "Web login" will appear at the top right. If you click on it, a browser opens in which username and password can be entered.

Notifications

In this menu you can turn on which notifications you do or do not want to receive as a pop-up on the screen and at what volume. To the right is notification on, to the left is notification off. With the top slider you turn all notifications on or off.

Back-up and restore

Make an external backup by clicking on it. This can be done to an SD card or USB stick that you put in the photo frame. The time of the last backup is shown here.

Automatic backup - The photo frame will automatically back up within 30 hours after you receive new photos or change the photo frame.

Reset frame - Deletes all data from the photo frame. This will permanently delete all photos, friends, connections and settings. Can be used, for example, when the photo frame is given to someone else.

Help

Share Anonymous Analytics Data -anonymous analytics data is a great help in improving the Frameo software. Check the box if you want to help improve Frameo. Clear this check box to deny sharing of anonymous analysis data.

Guide - Opens the quick start guide, which was also displayed when the photo frame was first started up.

About

Displays the information of the photo frame and the installed version of the software.

Check for updates - Check if an update is available for your frame.

Beta Program - Select whether you want to try new features before they are released to everyone.

Specifications

Dimension	257.3*176.4*22mm
Weight	335g
LCD	10 inch 1280*800 pixels,IPS
Processor	1.3 GHz, ARM Quad cortex-A7
Memory	512MB DDR RAM, 8GB built-in memory
Wifi	802.11b/g/n
OS	Android 6.0
Connection	DC jack 4.0 mm, USB, Micro-SD
Operating temperature	Between 0°C and 40°C